

## Invision HDTV-DXL Double Arm TV Wall Mount Instruction Manual

VESA Compliance 200(w)x100mm(h) - 600(w)x400mm(h)  
Recommended Screen Sizes 37" - 75"  
Integrated Cable Management  
Load Capacity 50kg (110lbs)

To receive large format PDF instructions please email [help@InvisionTechnology.co.uk](mailto:help@InvisionTechnology.co.uk)

### Parts List:

A -  (Φ10×Φ7×60)-6pcs	G -  (M6x25)-4pcs
B -  (7x80)-6pcs	H -  (M8x15)-4pcs
C -  (M6)-4pcs	I -  (M8x25)-4pcs
D -  (M6×20)-4pcs	J -  (M8x35)-4pcs
E -  (M6x8)-2pcs	K -  (M8x45)-4pcs
F -  (10-12mm)-1pcs	L -  (Φ16×Φ8.2×1.5)-14pcs
	M -  (Φ15×Φ8.2×5)-4pcs
	N -  (Φ15×Φ8.2×10)-4pcs
	O -  (Φ17×Φ8.2×12)-4pcs

### Tools List:



**First things first:** Check the box contains all the items in the parts list above.

**Check VESA Compatibility:** Please check the VESA measurements before drilling any holes (to check your TVs VESA, measure the distance between the mounting holes on the back of the TV).

**Check the weight of your TV:** You may need an extra person on hand to help.

Please wear safety glasses before using your drill – if in any doubt, consult your retailer or an experienced installer.

**You will need a few additional tools:** A drill and 10mm masonry drill bit or 4mm wood drill bit (depending on the fixing surface), a large Phillips screwdriver a pencil and a spirit level. You may choose to use a ratchet and 10/12mm socket but a 10/12 mm socket with Allen key is provided.

**Now please read the instructions fully and plan how to mount your TV bracket.**

### WARNING!

Severe personal injury and property damage can result from improper installation or assembly. Please read the following warning carefully before beginning.

- Product must be installed by a professional or competent installer.
- If you do not understand the instructions or have any concerns or questions please contact us or a competent installer.
- Do not install or assemble if the product or hardware is damaged or missing. If you require replacement parts, please contact us at Invision for assistance.
- This product fits most 37"-70" LCD/LED/plasma screen, maximum weight of LCD/LED/plasma screen 50kg (110lb).
- This product has been designed for use on vertical walls constructed of wood studs (minimum 2" x 4"/51mm x 102mm) or masonry (solid concrete 2000 PSI density minimum).
- For safe installation, the wall you are mounting must support minimum 3 times the weight of the total load (the TV bracket, the TV and all accessories).
- Do not use this product for any other application than the original design purpose.
- This product contains moving parts, please use with caution.
- When installing flat panel display, take care not to damage electrical wiring or power source.
- The manufacturer will bear no responsibility for mounting to the vertical wall, or incidental or consequential damages arising there from.
- The manufacturer disclaims any liability for the modifications, improper installation or installation over the specified weight range.
- The manufacturer will not be liable for any damages arising from the use of, or inability to use the product.

## Lets Get Started!

If you require assistance please contact us at: [help@InvisionTechnology.co.uk](mailto:help@InvisionTechnology.co.uk)

### Step 1 Unboxing

1. Lay the bracket flat and extend the bracket arms by holding the wall plate and pulling upwards on mounting plate.
2. Remove the 2x wall plate covers and put to one side - see diagram 'A'. Now remove 2x securing bolts using a screwdriver or Socket and Allen key 'F' and also put to one side (both wall plate covers and securing bolts will be used later on step 4).
3. Remove the mounting plate and put the rest of the bracket assembly to one side.

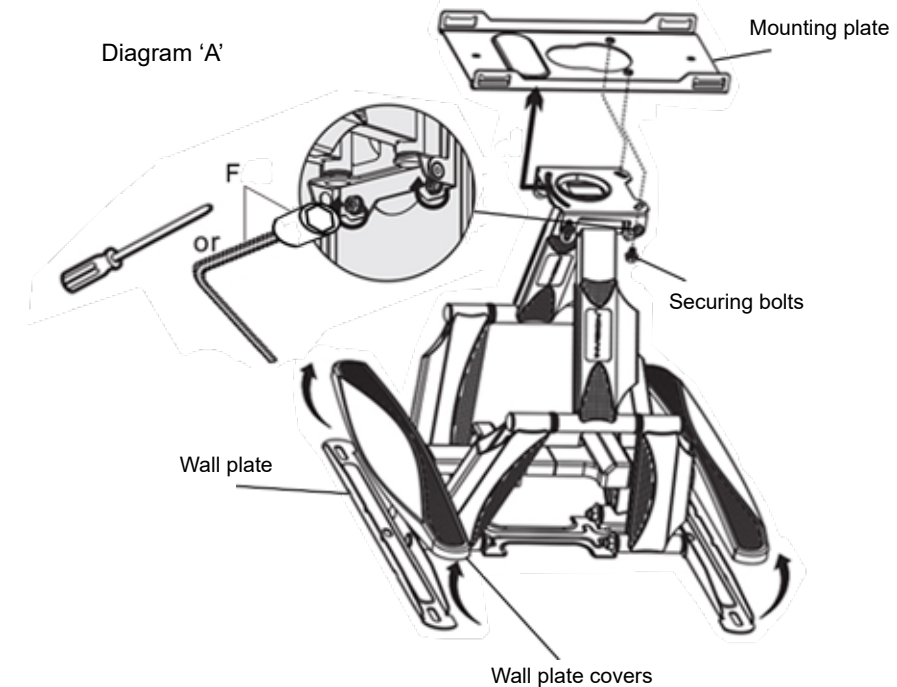

### Step 2a Assembling and Securing Mounting plate to TV

1. Slide both the longest rails '1.' through the mounting plate and secure with bolts 'E'.
2. Align the 2x shortest rails '2.' vertically so the notches engage with the horizontal rail '1'.
3. Slide to exact width of TV VESA measurements e.g. 400mm (w) x 200mm (h). Insert nuts and bolts 'C/D' and tighten assembly - see diagram 'B'.

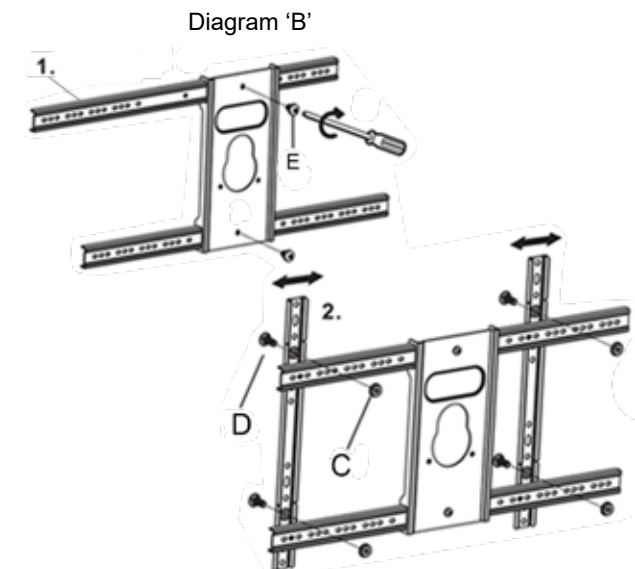
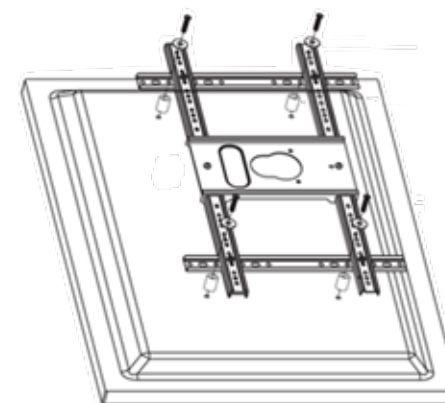

Diagram 'C'



Spacers and washers can be used in front or behind TV mounting assembly. Use bolts (G - O) to secure mounting assembly to TV.

### Step 2b

1. Lay TV face down onto a flat surface to access TV fixing points and position TV mounting assembly onto back of TV - see diagram 'C'.
2. Use relevant bolts, washers and spacers to secure the vertical rails of the TV mounting assembly to the back of your TV. (Spacers and washers can be used when shorter fixing bolts are required, clearance for cable access or if the rear of the TV is not flat).

### Step 3a Preparation

1. Mark on the wall where your bracket will fit using the wall fixing plate as a template or measure accurately between wall fixing plate mounting holes. Then mark accordingly using a spirit level and pencil (ensure mounting holes are clearly marked level horizontally and vertically on the wall).

This bracket is designed to be attached to either fixed wooden studs within traditional plasterboard (drywall) walls or into solid brick or concrete walls.

### Step 3b Wood Stud Installation

1. For mounting to wooden studs – carefully locate the wooden stud and mark the position of the holes level vertically and drill into the wood using a **4mm** drill bit drill to a depth of **80mm**.

2. To mount your bracket hold in position and insert the supplied screws 'B' into washers 'L' and fully tighten into the wood using a ratchet and 12 mm socket or Socket (12mm side) and Allen key 'F' - see diagram 'D'.

**Plastic plugs are not required but you may need additional plasterboard fixings for fixing holes that do not land on a stud.**

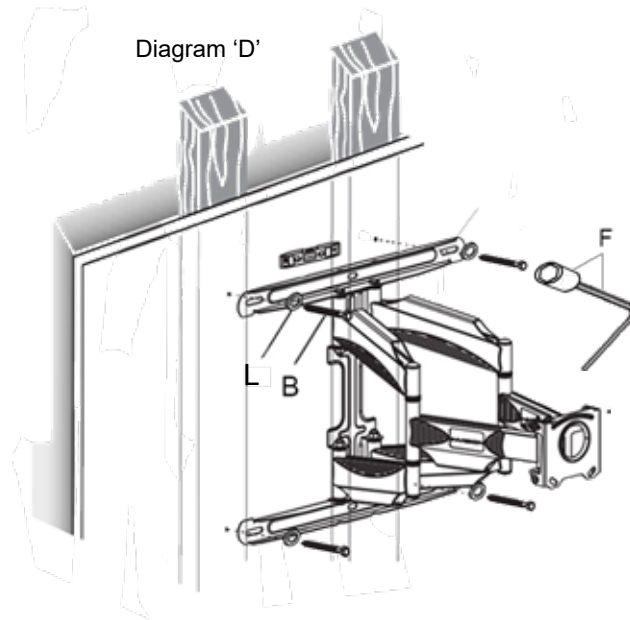
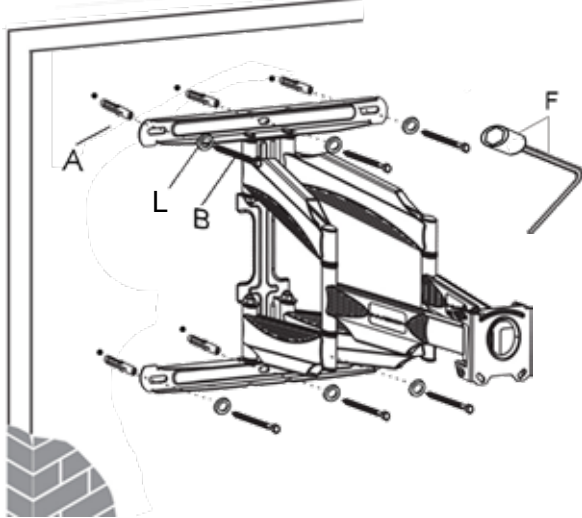

Diagram 'E'



### Step 3c Brick & Concrete Installation

1. For mounting to concrete or brick walls, please mark the wall carefully and using a **10mm** masonry drill bit drill to a **full depth of 80mm minimum ensuring the holes drilled are free from debris** - see Step 3d and diagram 'F'.

2. Fully insert the plastic plugs 'A' into the solid wall (pushed beyond any plaster). Please ensure they fit securely and are not visible in the holes.

3. Insert screws 'B' into washers 'L' and fully tighten into the plastic plugs using a ratchet and 12mm socket or Socket (12mm side) and Allen key 'F' until secure - see diagram 'E'.

### Step 3d

Many modern houses have an air-gap behind plasterboard or drywall. Our fixings are only designed to work with the plastic plug fully inserted into the masonry that lies behind any plaster or drywall air gap. To use our fixings in this way **YOU MUST** insert the plug past any plaster/drywall and fully into the underlying masonry to gain a secure fixing. (The drill depth may have to be increased to make sure the plug can be fully inserted into the masonry).

When fitting, the screw must be at least 3/4 of the way into the plug, and the plug must be fully inserted into brick or concrete to be effective.

Depending on the plasterboard/dry wall air gap you may need to purchase longer fixings to ensure a secure fix.

Diagram 'F'

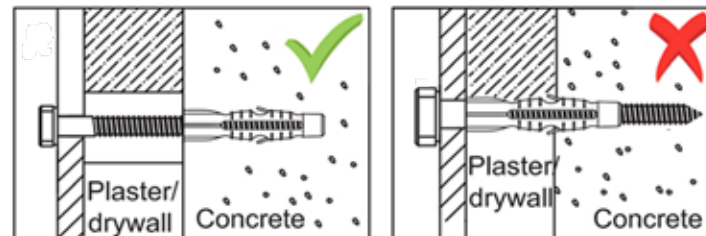

**WARNING**  
Please see diagram right for correct installation of screws & plugs

### Step 4 Securing and Level Adjustment of TV

**Two people are recommended to complete this step**

1. Carefully lift the TV and mounting plate assembly and hook the keyhole slot (1.) on to the wall brackets circular securing point (2.) - see diagram 'G'.

**Before letting go pull down gently to test TV is located securely whilst keeping a firm grip of the TV.**

2. Once located in place, replace and finger tighten the 2x securing bolts which were removed in Step 1. Adjust the TV until level and once positioned tighten both security bolts with either screwdriver, ratchet and 10mm socket or Socket (10mm side) and Allen key 'F'.

3. Re-attach the wall plate covers removed in step 1.

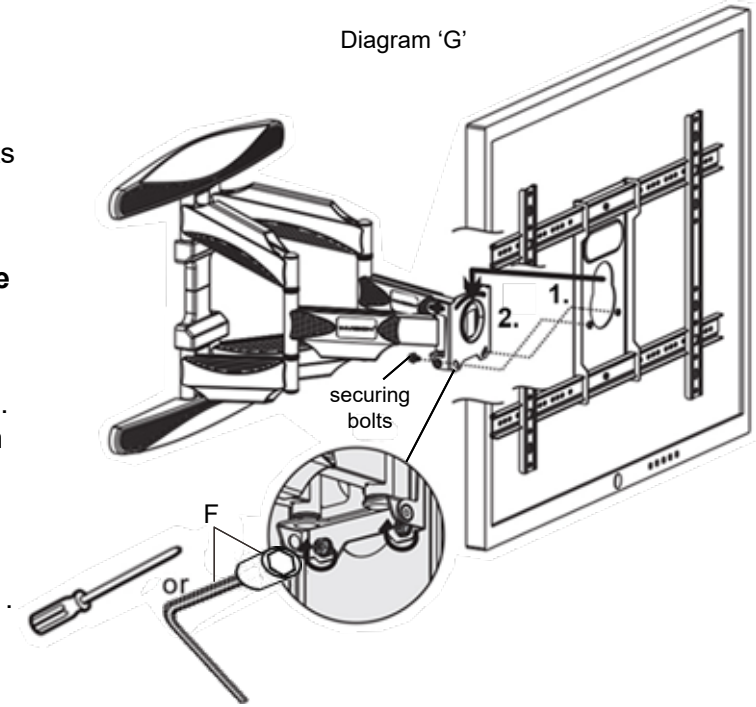
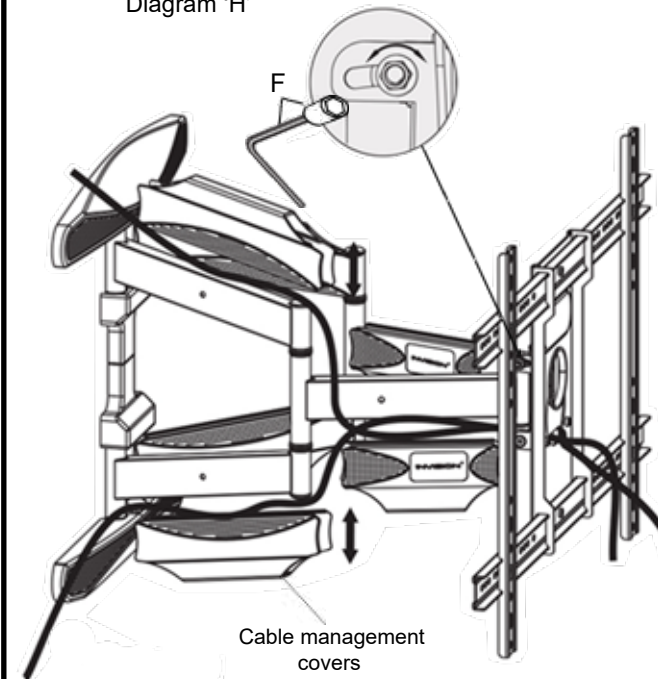

Diagram 'H'



### Step 5 Cable Management and Tilt Adjustment

1. Route TV cables along arms of bracket, leaving slack around joints and clip on the cable management covers - see diagram 'H'.

2. To set tilting operation, tighten to required torque using ratchet and 10mm socket or Socket (10mm side) and Allen key 'F' so the TV tilts freely by hand, but not of its own accord.

### Troubleshooting:

Don't panic! In case of any issues with compatibility or for any advice on fitting, please contact our team at [help@InvisionTechnology.co.uk](mailto:help@InvisionTechnology.co.uk) and we will help you overcome any problems. All our products carry our Compatibility Promise.

**Your installation is now complete - Sit back & enjoy!**

**To activate your 25 year warranty please email your name, order number and product ref HDTV-DXL to: [warranty@InvisionTechnology.co.uk](mailto:warranty@InvisionTechnology.co.uk)**