

Invision FX100

Ergonomic Gas Assisted Monitor/ TV Wall Mount

Instruction Manual

VESA Compliance 75x75mm & 100x100mm
Recommended Screen Sizes 17" - 27"
Integrated Cable Management
Load Capacity 2 - 7 kg (4.4 - 15.4lbs)

To receive large format PDF instructions please e-mail
help@invisiontvbrackets.com

Parts List:

- A - (M4x12)-4pcs
B - (M5x12)-4pcs
C - (10-12mm)-1pcs
D - (7x80)-2pcs
E - (16x8 2x1.5)-2pcs

Tools List:



First things first: Check the box contains all the items in the parts list above.

Check VESA Compatibility: Please check the VESA measurements before drilling any holes (to check your TV/Monitor VESA, measure distance between mounting holes on back of the TV/Monitor).

Check the weight of your TV/Monitor: You may need an extra person on hand to help!

You will need a few additional tools: A drill and 10mm masonry drill bit or 4mm wood drill bit, depending on the fixing surface, a large Phillips screwdriver, a pencil, a spirit level and a 12mm socket and ratchet (a 12mm socket can be used with the Allen key which are supplied – Parts C & G).

Please wear safety glasses before using your drill – if in any doubt, consult your retailer or an experienced installer.

Now please read the instructions fully and plan how to install your wall mount!

WARNING!

- Severe personal injury and property damage can result from improper installation or assembly. Please read the following warnings carefully before beginning.
- Do not install or assemble the product or hardware if damaged or missing. If you require replacement parts, please contact us at help@invisiontvbrackets.com.
 - This product has a maximum weight of 15.4kg (34 lbs).
 - This product has been designed for use on vertical walls constructed of masonry (brick or concrete).
 - For safety reasons, the wall you are mounting must support minimum 3 times the weight of the total load (the TV bracket, the TV and its accessories).
 - Do not use this product for any other application than the original design purpose.
 - This product contains moving parts, please use with caution.
 - Please do not use this product for any other application than the original design purpose.
 - The manufacturer will bear no responsibility for mounting to the vertical wall, or incidental or consequential damages arising from them.
 - The manufacturer disclaims any liability for the modifications, improper installation or installation onto the specified weight range.
 - The manufacturer will not be liable for any damages arising from the use of, or inability to use the product.
 - The product contains a high pressure gas spring. The mechanism is not to be used for any other purpose than its original design purpose.
 - In order to ensure the performance of the gas spring, it is recommended to fully extend the arm at least once per month.

Lets Get Started!

If you require assistance please contact us at: help@invisiontvbrackets.com

Step 1 - Preparing your Wall Mount

1. Open the box and take out the wall mount. Remove 2x wall plate cover caps as shown in Diagram 'A' and put them to one side.

(Important: DO NOT attempt to adjust the tension of the wall mount before mounting on the wall).

Diagram 'A'

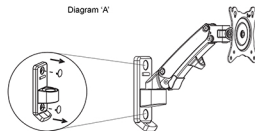

Tip: Use one of the fixing screws and push through the hole on the back of the wall plate to release the cover caps

Step 2 - Positioning and Marking Out

1. Before marking out note the centre line of the TV will be 166mm offset to the wall fixing centre line when the wall mount is pushed back to the wall - see diagram 'B'. Also take into consideration the length of cables you are using with your equipment leaving an adequate amount of slack so the wall mount can function properly.
2. Position the mount on the wall using the wall fixing plate as a template and mark out the 2 holes using a spirit level and pencil. (Ensure your markings are clearly marked level both horizontally and vertically on the wall) - see diagram 'C'

Diagram 'B'

Diagram 'C'

Display Centre

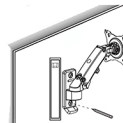
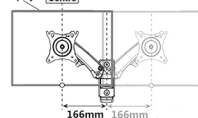

Step 3 - Securing Wall Mount to your Wall

This wall mount is designed to be attached to either fixed wooden studs within traditional plasterboard (drywall) walls or into solid masonry (brick or concrete) walls.

Step 3a - Wood Stud Installation

- For mounting to wooden studs – carefully locate the wooden stud and mark the position of the holes level vertically and drill into the wood using a 4mm drill to a depth of 80mm - see diagram 'D'.
- Hold your wall mount in position and insert the supplied screws and washers, check the wall mount is level and fully tighten into the wood using a 12mm socket set or parts 'C/G' socket and Allen key (plastic plugs are not required when fixing into wood) - see diagram 'E'. Replace wall plate cover caps once the wall mount is secure.

Diagram 'D'

Diagram 'E'

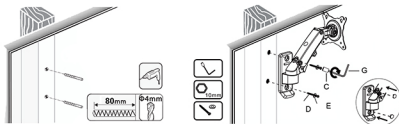

Step 3b - Masonry Installation (Brick & Concrete)

- For mounting to masonry walls, please mark the wall carefully and drill using a 10mm masonry drill bit to full depth of 80mm minimum ensuring the holes drilled are free from debris - see Step 3c diagram 'H'.
- Fully insert the plastic plugs 'F' into the solid wall (pushed beyond any plaster) closely following diagram 'F'.
- Insert screws 'D' and fully tighten into the plastic plugs using a ratchet and 12mm socket set or parts 'C/G' socket and Allen key until secure - see diagram 'G'.

Diagram 'F'

Diagram 'G'

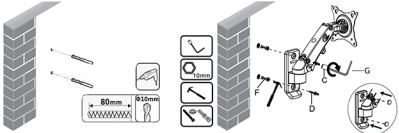

Step 3c - Please Note

Many modern houses have an air-gap behind plasterboard or drywall. Our fixings are only designed to work with the plastic plug fully inserted into the masonry that lies behind any plaster or drywall air gap. To use our fixings in this way **YOU MUST** insert into the plug past any plaster/drywall and fully into the underlying masonry to gain a secure fixing. (The drill depth may have to be increased to make sure the plug can be fully inserted to the masonry).

When fitting, the screw must be at least 3/4 of the way into the plug, and the plug must be fully inserted into the masonry to be effective - see diagram 'H'.

Depending on the plasterboard/dry wall air gap you may need to purchase longer fixings to ensure a secure fix (plasterboard wall fixings are **NOT** supplied).



WARNING
Please see diagram right for correct installation of screws & plugs

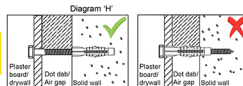

Step 4 - Mounting your Monitor/TV

- Check TV/monitor VESA by measuring the distance between the mounting holes on the back of the screen - this is where bolts A/B will fit.
- Screw 2 bolts into the top two holes on the back of the TV/monitor using bolts A or B and tighten in 3 turns leaving 5mm of room between the bolt head and rear of screen for hanging - see diagram 'T'.
- Carefully lift TV/monitor and hang onto the VESA plate - see diagram 'J'.
- Fit the bottom 2 bolts into the VESA plate and tighten all the bolts - see diagram 'K'.

Please Note: Set the torque of arm if screen moves down too easily (see Step 5)

Diagram 'T'

Diagram 'K'

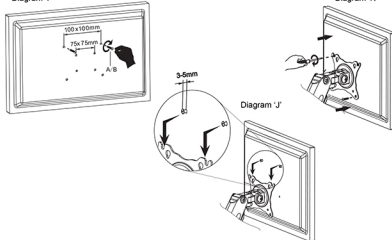

Step 5 - Using Your Invision FX100 Wall Mount

Setting the tension of the wall mount to balance the weight of the TV/monitor

Once fitted the screen may rise or lower depending on the TV/monitors weight. From minimum tension to maximum tension there are 19x full rotations. When making adjustments make one full turn of the Allen key and check by depressing the upper arm to see if the TV/monitor is balanced evenly.

1. If the screen moves upwards of its own accord then adjust the tension using the 5mm Allen key 'G' and wind the set screw in the minus direction (clockwise) - see diagram 'L'.
2. If the screen moves downwards of its own accord then adjust the tension using the 5mm Allen key 'G' and wind the set screw in the plus direction (anti-clockwise).

Continue to make adjustments until the TV/monitor weight feels equal to the tension of the wall mount. It should hold in place when positioning the TV/monitor and not raise or lower of its own accord.

Diagram 'L'

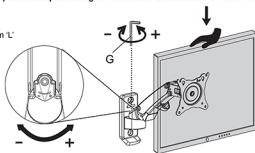

Step 6 - Cable Management

Please leave adequate slack while routing cables

1. Remove the upper cable management clip by removing the screw - see diagram 'M'.
2. Route all cables up through the base cable management clip.
3. Feed the cables into the upper cable management clip and re-attach the screw.

Diagram 'M'

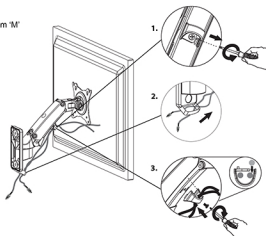

Step 7 - Adjusting the Tilt Angle

The tilt can be set to your desired viewing angle by simply moving the screen backwards and forwards by hand. If you find the screen moves forward of its own accord, the tilt adjustment can be tightened using Allen key 'G' - see diagram 'N'.

Diagram 'N'

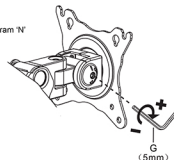

Step 8 - Rotational Features

Your monitor arm allows you to rotate your screen through 360 degrees to view in portrait mode or landscape mode providing the VESA mount on your screen is central.

Please Note:

Beware of trapping or breaking cables when rotating TV/Monitor. DO NOT ROTATE MORE THAN 90 DEGREES IN EACH MOTION

Diagram 'O'

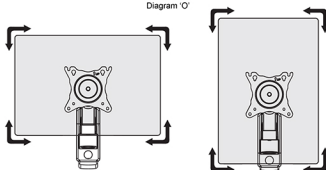

Troubleshooting:

Don't panic! In case of any issues with compatibility or for any advice on fitting, please contact our team at help@invisiontvbrackets.com and we will help you overcome any problems. All our products carry our Compatibility Promise.

Your installation is now complete - Sit back & enjoy!

To activate your 3 year warranty please email your name and product ref FX100 to warranty@invisiontvbrackets.com